

# INSTRUCTION

## PACKAGE CONTENTS

PART	DESCRIPTION	QTY.
A	Engine LED	1
B	Wire Clip	2
C	Screws	3
D	Switch	1
E	LED Driver 120V / 10V	1

## WARNINGS AND CAUTIONS

- WARNING:** • Review important safety instructions before installation.  
Deviation from the assembly instructions may result in a risk of fire or electric shock.
- CAUTION:** • Risk of exposure to excessive ultraviolet (UV) radiation.  
• Do not operate without complete bulb (lamp) enclosure in place or if lens is damaged.  
Save these instructions.

## IMPORTANT SAFETY INSTRUCTIONS

### INSTRUCTIONS PERTAINING TO A RISK OF FIRE, ELECTRIC SHOCK, EXPOSURE TO EXCESSIVE UV RADIATION, OR INJURY TO PERSONS.

**WARNING - Do not operate your fixture without the glass lenses in place.**

**UNDER CABINET ONLY – MINIMUM  
SPACING 12 INCHES ON CENTER.**

**Lighted Lamp is Hot !**

### **WARNING – TO reduce the risk of FIRE, ELECTRIC SHOCK EXPOSURE TO EXCESSIVE UV RADIATION, OR INJURY TO PERSONS:**

1. Do not touch HOT lens, guard, or enclosure.
2. Do not remain in light if skin feels warm.
3. Do not look directly at lighted bulb.
4. Keep lamp away from materials that may burn.
5. Use a soft cloth to touch the bulb. Oil from skin may damage bulb.
6. Do not operate the lamp with a missing or damaged lens; lens acts as guard/shield and UV light filter.
7. Use only insulation staples or plastic ties to secure the cords.
8. Route and secure the cords so that they will not be pinched or damaged when the cabinet is pushed to the wall.
9. Do not use an extension cord. Use power strip with integral overcurrent protection to supply other electrical devices or accessories in cabinet.
10. Keep cord or combustible such as plastic, paper goods, and the like away from hot lamp, lampholder, or reflector.
11. Position cabinet light with respect to cabinet so as to permit reading of the lamp replacement markings during relamping.
12. Not intended for illumination of aquariums.
13. Not intended for installation in plastic cabinets.
14. Not intended for recessed installation in ceilings or soffits.
15. The low voltage portable cabinet light may be installed in a kitchen cabinet or other built-in furniture when:
  - A. The low voltage power supply (transformer) is located outside the cabinet and not concealed.
  - B. The line voltage power supply cord is not concealed or run through cabinet openings. This requirement does not apply to the wiring between the cabinet light and the power unit.
16. Do not conceal line voltage power supply cord or power supply inside a wall, ceiling soffit, kitchen cabinet, or similar permanent structure.
17. Do not run line voltage power supply cord through holes in walls, ceilings, or floors.

## POWER CONNECTIONS

**DO NOT ATTEMPT TO TEST YOUR SYSTEM WITHOUT THE NYLON CONNECTOR PLUGS INSTALLED! YOU CAN PERMANENTLY DAMAGE THE TRANSFORMER IF THE METAL TERMINAL PINS ARE ACCIDENTALLY SHORTED; THIS WILL VOID YOUR WARRANTY.**

1. Route the transformer power connectors to the individual head. If routing has to be done through adjoining cabinet walls, you will need to drill the holes through cabinet walls in order to route the power plugs to the individual head locations. DO NOT route the 120V input line cord through fixed cabinet walls.
2. Once the power connector wires have been routed and in place, you can use the wire guides (included) to keep the wires in place.

## PREPARATION

Before beginning assembly, installation or operation of product, make sure all parts are present. Compare parts with package contents list and diagram above. If any part is missing or damaged, do not attempt to assemble, install or operate the product. Contact customer service for replacement parts.

Estimated Assembly Time: 30 minutes

Tools Required For Assembly (not included):

Flathead Screwdriver

Philips Screwdriver

Safety Glasses

Drill

1/16 in. Drill Bit

Hammer  
Soft Cloth

## ASSEMBLY AND INSTALLATION INSTRUCTIONS

### SURFACE MOUNTING

1. Locate desired position for the cabinet light.
2. Remove the lens cover from housing by rotating counterclockwise.
3. Route the wire through surface can notch, or if desired, drill a hole through the mounting surface and route wires through hole. Be sure to position the surface can so the notch faces the rear of the cabinet.
4. Make sure there is no contact between the hot lamp, lampholder, or reflector, and any combustible material such as plastic or paper goods, or the wire insulation.
5. Mount surface can and housing assembly with the three wood screws provided (tools not supplied).
6. Replace lens cover by rotating clockwise.
7. To prevent the risk of fire, do not install closer than 2 inches to cabinet wall or side walls.

### RECESSED MOUNTING

**(CAUTION) Risk of fire, install as recessed only where top of cabinet light housing is not enclosed.**

1. Drill a 2-1/8 inch hole in the desired location.
2. Remove the lens cover from housing by rotating counterclockwise.
3. Remove the trim ring. Do not use trim for recessed applications.
4. Feed wires through hole and push light housing into hole. Make sure there is no contact between the hot Lamp, lampholder, or reflector, and the wire or any combustible material such as plastic or paper goods. Secure the light supply leads to avoid the likelihood of the leads contacting the cabinet light.
5. Replace lens cover by rotating clockwise.

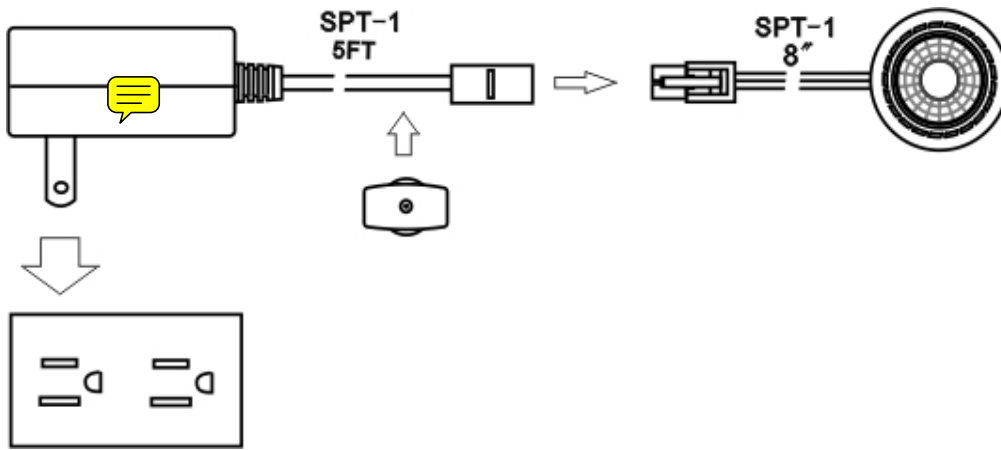

### SURFACE/RECESSED

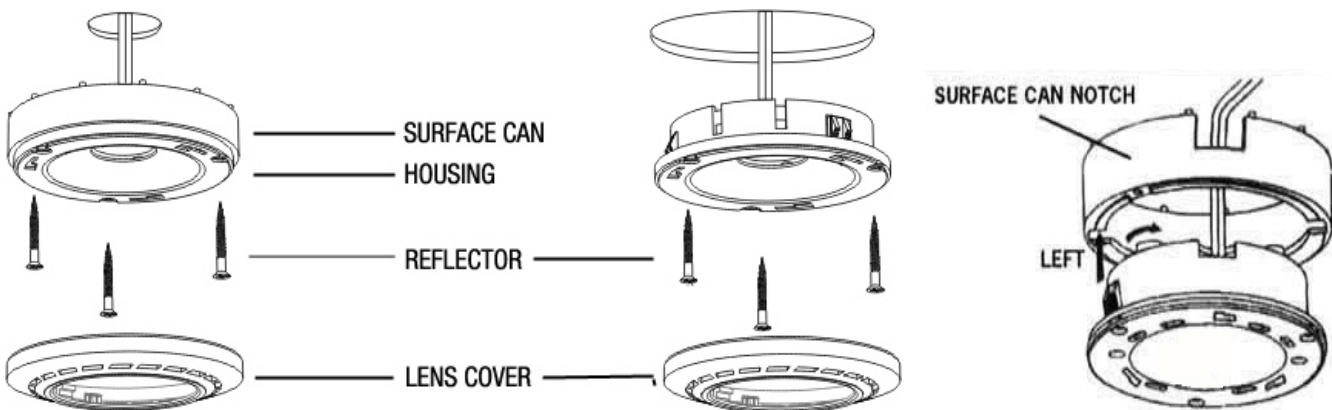

### ONE-YEAR LIMITED WARRANTY

The manufacturer warrants this product to be free from defects in workmanship and material present at time of shipment from the factory for one year from the date of purchase. This warranty applies only to the original purchaser. The manufacturer agrees to correct such defect at no charge or at our option replace the product with a comparable or superior model.

To obtain warranty service, call our customer service department at 1-800-265-1833 for return authorization and shipping instructions. You may be required to present a copy of your sales receipt as proof of purchase. All cost of removed and reinstallation are the expressed responsibility of the purchaser. Any damage to the product by accident, misuse or improper installation, or by affixing accessories not produced by the manufacturer, are the purchaser's responsibility. The manufacturer assumes no responsibility whatsoever for product installation during the warranty period.

Printed in China